

## U-Handles

Handle Bar Aluminum / Handle Shanks Plastic,  
for 19" Rack and Enclosure Layout

### SPECIFICATION

#### Types

- Type **A**: Mounting from the back (Self-tapping screws)
- Type **B**: Mounting from the operator's side

#### Handle bar

Aluminum

- Anodized, natural color **ELS**  
Handle shanks black, matte finish
- Anodized, natural color **ELG**  
Handle shanks light gray, matte finish
- Anodized, Black **ESS**  
Handle shanks black, matte finish

#### Handle shanks

Plastic, Polyamide (PA)

- Glass fiber reinforced
- Operating temperature up to 130 °C

#### Self-tapping screw for type A

ISO 7049

Steel zinc plated ST4,8-19

#### Fastening set for type B

- Socket cap screws ISO 4762-M5-45  
Steel zinc plated, black finish
- Flange nuts DIN 1661-M5  
Steel zinc plated, blue passivated



### INFORMATION

The dimensions of the U-handles GN 423 have been designed to match a 19" rack and enclosure layout.

The values of the height unit HE given in the table refer to the corresponding front panel heights of the housings.

Handle bar and handle shanks are interconnected via a plug-type connection, with the effect that special lengths are easily realised.

Thanks to the fixing screws included in the set, the U-Handles are easily and economically mounted.

### TECHNICAL INFORMATION

- Load Rating Information (see page A35)
- Plastic Characteristics (see page A2)

\* Complete with

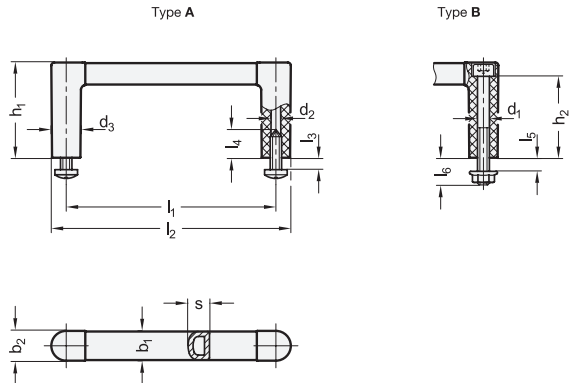

### GN 423-A

Description	b1	l1	b2	d2	d3	h1	l2	l3 max.	l4 min.	s	HE	⚖
GN 423-12-55-A-*	12	55	12.5	4.3	12.5	40	67.5	5	14	9	2	27
GN 423-12-88-A-*	12	88	12.5	4.3	12.5	40	100.5	5	14	9	3	31
GN 423-12-100-A-*	12	100	12.5	4.3	12.5	40	112.5	5	14	9	3	34
GN 423-12-120-A-*	12	120	12.5	4.3	12.5	40	132.5	5	14	9	4	37
GN 423-12-180-A-*	12	180	12.5	4.3	12.5	40	192.5	5	14	9	5	50
GN 423-12-235-A-*	12	235	12.5	4.3	12.5	40	247.5	5	14	9	6	59

### GN 423-B

Description	b1	l1	b2	d1	d3	h1	h2	l2	l5 max.	l6	s	HE	⚖
GN 423-12-55-B-*	12	55	12.5	M 5	12.5	40	34.5	67.5	5	10.5	9	2	38
GN 423-12-88-B-*	12	88	12.5	M 5	12.5	40	34.5	100.5	5	10.5	9	3	43
GN 423-12-100-B-*	12	100	12.5	M 5	12.5	40	34.5	112.5	5	10.5	9	3	46
GN 423-12-120-B-*	12	120	12.5	M 5	12.5	40	34.5	132.5	5	10.5	9	4	48
GN 423-12-180-B-*	12	180	12.5	M 5	12.5	40	34.5	192.5	5	10.5	9	5	59
GN 423-12-235-B-*	12	235	12.5	M 5	12.5	40	34.5	247.5	5	10.5	9	6	68

Weight ELS